

Brushes



Description

Brush assemblies are suitable for lubricating various moving machine components such as chains, cams, open gears...
Oil flow to each brush must be controlled by a meter unit or a control unit.
The brush must be mounted close to the component to be lubricated, but the bristles should not be in contact.

Characteristics

- Material: anodised aluminium body
nylon Ø 0,3
(bristle for standard version)
brass Ø 0,1
(bristle for "L" version)
- Working temperature: -30 to 95°C
(standard version)
up to 300°C
("L" version)
- Connection: 1/8 NPT or 5/16-24NF

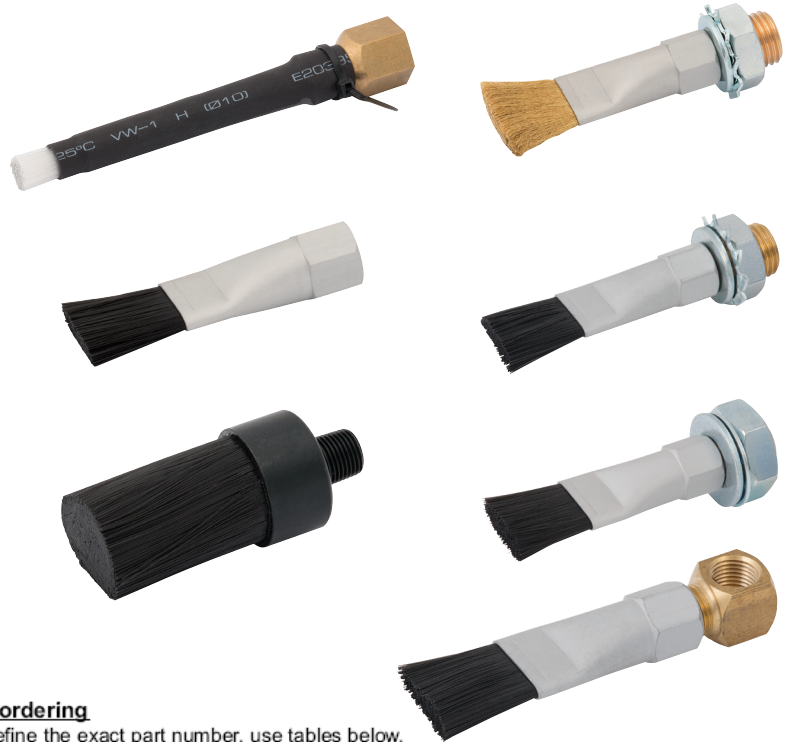

Figure 1

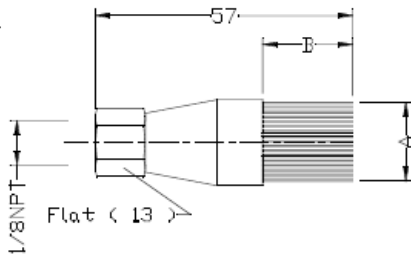

Figure 2

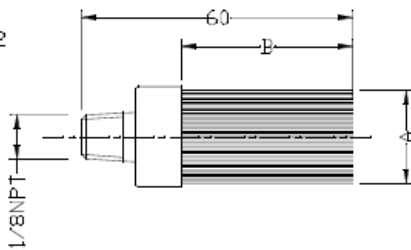
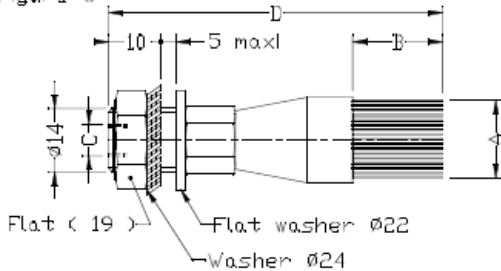

Figure 3



For ordering

To define the exact part number, use tables below.
Example : Brush, width 19MM, brass bristles, 1/8NPT
Reference : **B7492L**

Figure	Sizes			Bristle material	Reference
	A	B	C		
1	20x4	19	1/8NPT	nylon	B7488
	20x4	19	1/8NPT	brass	B7488L
	30x4	19	1/8NPT	nylon	AR1473

Figure	Sizes			Bristle material	Reference
	A	B	C		
2	48x14	35	1/8NPT	nylon	80311
	ø25	35	1/8NPT	nylon	80310

Figure	Sizes				Bristle material	Reference
	A	B	C	D		
3	20x4	19	5/16-24NF	74	nylon	B7491
	20x4	19	5/16-24NF	74	brass	B7491L
	30x4	19	5/16-24NF	74	nylon	AR1530
	ø25	35	5/16-24NF	90	nylon	AR1583
	48x14	35	5/16-24NF	90	nylon	AR1585
	20x4	19	1/8NPT	74	nylon	B7492
	20x4	19	1/8NPT	74	brass	B7492L
	30x4	19	1/8NPT	74	nylon	AR1531
	ø25	35	1/8NPT	90	nylon	AR1584
	48x14	35	1/8NPT	90	nylon	AR1586
	20x4	19	M8x100	74	nylon	AR1964
	20x4	19	M8x100	74	brass	AR1965
	30x4	19	M8x100	74	nylon	AR1966
	ø25	35	M8x100	90	nylon	AR1967
	48x14	35	M8x100	90	nylon	AR1968