

# 316 Stainless Steel DIN 2353 Tube Fittings

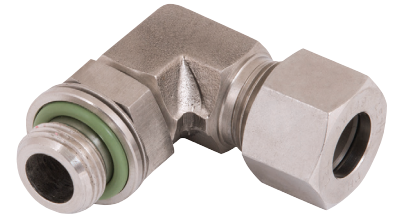

EDELSTAHL / STAINLESS STEEL  
VERBINDUNGSTECHNIK  
FLUID CONNECTORS

## 90° Compact Adjustable Elbows

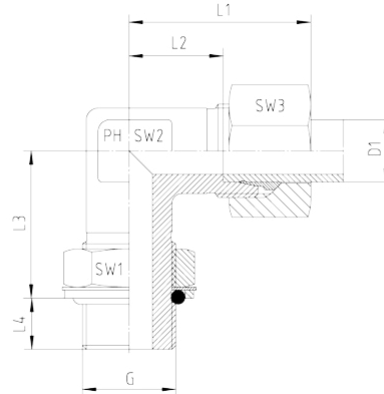

Adjustable Elbow Couplings with Locknut  
For Port with small and large countersink  
Sealing by O-Ring (Viton) with Retaining Ring (ISO 1179)

Series L											
Part Number	Pressure	Tube O.D.	Thread	Approx. Dimensions							
	PN	D1	G = BSP	D1	L1	L2	L3	L4	SW1	SW2	SW3
WEEV-06L-1/8	315	6	G 1/8"	6	29	14	19	7	14	14	14
WEEV-08L-1/4	315	8	G 1/4"	8	31	16	23	9	19	14	17
WEEV-10L-1/4	315	10	G 1/4"	10	32	17	25	9	19	19	19
WEEV-12L-3/8	250	12	G 3/8"	12	34	19	28	9	22	19	22
WEEV-15L-1/2	250	15	G 1/2"	15	36	21	30	13	27	19	27
WEEV-18L-1/2	250	18	G 1/2"	18	40	24	36	13	27	27	32
WEEV-22L-3/4	160	22	G 3/4"	22	44	28	36	13	36	27	36
WEEV-28L-1	160	28	G 1"	28	47	31	44	15	41	36	41
WEEV-35L-1 1/4	160	35	G 1.1/4"	35	59	38	50	15	50	50	50