

90° Gas Ball Valves



MATERIALS

Body: Brass CW617N-UNIEN12165
 Ball: Brass CW617N-UNIEN12165 chrome-plated
 Sleeve, Stem, Nut: Brass CW614N-UNIEN12164
 Seals: pure PTFE
 O-Rings: Nbr+Fkm
 Seeger: bronze
 Seeger for the nut: Stainless steel
 Handle: Aluminium EN-AB46100
 Screw: Zincplated steel



Working temperature: -20° +60°C

Max pressure: 5 bar (Mop5)

Nut's thread: UNI ISO 228/1

Other threads: UNI EN 10226-1 (ex ISO7/1)

Conforming with: UNI EN 331

FINAL TEST conforming with UNI EN 12266-1 points A3 or A4

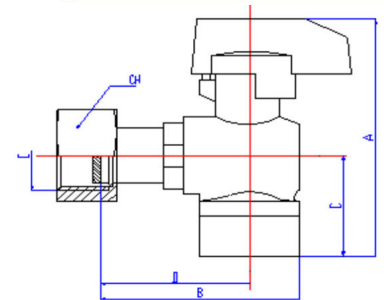

Misura Size f. - nut	A	B	C	D	E	CH	DN
1/2" x 1/2"	66,6	50	25,6	37	1/2"	24	10
1/2" x 3/4"	66,6	46	25,6	33	3/4"	30	10