

# Standpipes, Swept 45°

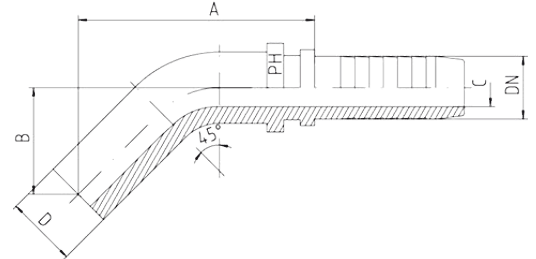
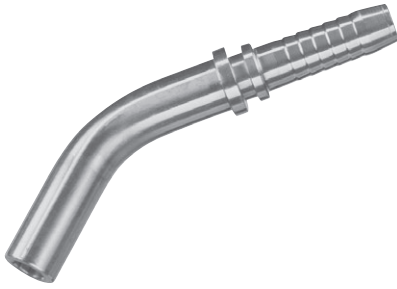

- Light Series = BEL 45° elbow
- Heavy Series = BES 45° elbow

## Light Series

Hose DN	Bore	Tube OD D	Approx. Dimensions			Order Code
			A	B	C	
05	3/16"	6	50.0	22.0	3.0	BEL-06-45-DN05
06	1/4"	6	51.0	21.0	4.0	BEL-06-45-DN06
06	1/4"	8	60.0	22.0	4.0	BEL-08-45-DN06
06	1/4"	10	65.0	22.5	4.0	BEL-10-45-DN06
08	5/16"	10	64.5	25.0	5.5	BEL-10-45-DN08
10	3/8"	10	64.0	24.5	7.0	BEL-10-45-DN10
08	5/16"	12	59.0	24.0	5.5	BEL-12-45-DN08
10	3/8"	12	59.0	24.5	7.0	BEL-12-45-DN10
12	1/2"	15	69.0	27.5	9.5	BEL-15-45-DN12
16	5/8"	18	73.0	34.0	12.5	BEL-18-45-DN16
19	3/4"	22	92.0	41.5	14.5	BEL-22-45-DN19
25	1"	28	108.0	47.0	20.0	BEL-28-45-DN25
31	1.1/4"	35	144.0	68.0	25.5	BEL-35-45-DN31
38	1.1/2"	42			31.5	BEL-42-45-DN38

## Heavy Series

Hose DN	Bore	Tube OD D	Approx. Dimensions			Order Code
			A	B	C	
05	3/16"	6	50.0	22.0	3.0	BES-06-45-DN05
06	1/4"	6	51.0	21.0	4.0	BES-06-45-DN06
06	1/4"	8	60.0	22.0	4.0	BES-08-45-DN06
06	1/4"	10	65.0	22.5	4.0	BES-10-45-DN06
08	5/16"	10	64.5	25.0	5.5	BES-10-45-DN08
10	3/8"	10	64.5	25.0	7.0	BES-10-45-DN10
08	5/16"	12	59.0	24.0	5.5	BES-12-45-DN08
10	3/8"	12	48.0	45.0	7.0	BES-12-45-DN10
10	3/8"	14			7.0	BES-14-45-DN10
12	1/2"	16	78.0	32.0	9.5	BES-16-45-DN12
16	5/8"	20	71.5	31.0	12.5	BES-20-45-DN16
19	3/4"	25	96.0	42.0	14.5	BES-25-45-DN19
25	1"	30			20.0	BES-30-45-DN25
31	1.1/4"	38			25.5	BES-38-45-DN31