

# Test Point Nipple

# Wade

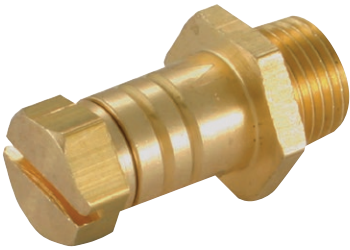

## Features & Benefits

- Range includes in-line tube to tube unions, tube to tube elbows and 1/8" BSP taper male nipples
- Designed to provide a pressure test point for LPG and natural gas systems
- Conform to BS 4161
- Compression ends are designed and manufactured to BS 2051
- Wade test point fittings are widely used on caravan and boat pipe installations where EU regulations stipulate the fitting of test points on gas system pipework

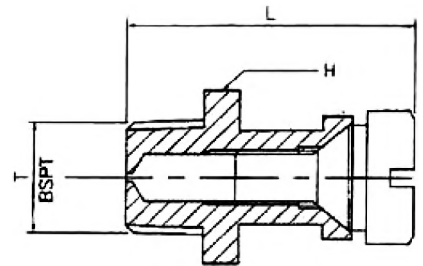

Part No	T BSPT Male Thread	L Length	H Hex A/F
WADE-SK4157COMP	1/8"	0.95"	0.512"