

Malleable Iron Fittings

Female Equal Tee 90° (130)

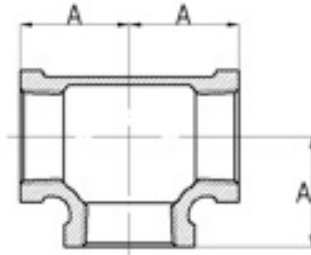

Size		Dimensions (mm)
Inch	mm	A
1/8	6	17.5
1/4	10	20
3/8	10	23.5
1/2	15	26.5
3/4	20	31
1	25	36.5
1 1/4	32	43.5
1 1/2	40	47.5
2	50	55.5
2 1/2	65	67
3	80	75.5
4	100	94
5	125	114
6	150	128.5

Female Unequal Branch Tee 90° (130R)

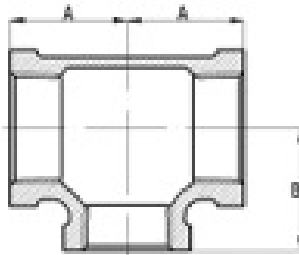

Size		Dimensions (mm)	
Inch	mm	A	B
3/8X1/8	10X6	20.5	21.5
3/8X1/4	10X8	22	22.5
1/2X3/8	15X10	26	26
1/2X1/8	15X6	22	23
1/2X1/4	15X8	24	24
3/4X3/8	20X10	28	28
3/4X1/2	20X15	28.5	29.5
3/4X1/4	20X8	26.5	27
1X3/8	25X10	30	32
1X1/2	25X15	31	32
1X3/4	25X20	33	34
1X1/4	25X8	28	31
1 1/4X3/8	32X10	31	35
1 1/4X1/2	32X15	32.5	37
1 1/4X3/4	32X20	35	39.5
1 1/4X1	32X25	39	41
1 1/4X1/4	32X8	30	36.5
1 1/2X3/8	40X10	34	39
1 1/2X1/2	40X15	34.5	41
1 1/2X3/4	40X20	37	42
1 1/2X1	40X25	40	44
1 1/2X1 1/4	40X32	44	47