

Quick Release Pneumatic Hose Couplings



SSC Claw Couplings

SS3 Male Thread, BSPP

- Extremely robust, durable coupling of forged steel, hardened, zinc plated and yellow passivated (free of chrome VI), equivalent to type Atlas Copco
- With oil-resistant rubber ring GOER, on request with steam-resistant rubber ring GDOR (up to 200°C) against extra charge
- Maximum bore for maximum flow capacity to reach full tool performance
- Turned gasket seat, therefore 100% tight
- Turned stem profile for perfect fit of the hose
- High quality coupling for compressed air in construction and industry

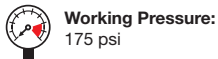

Working Pressure:
175 psi

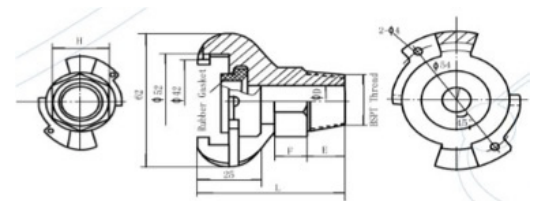

| PART NO | SIZE | L | E | F | H | D | W.P |
|---------|------|----|----|----|----|----|--------|
| SS312 | 1/2" | 59 | 24 | 10 | 30 | 14 | 175psi |
| SS334 | 3/4" | 50 | 17 | 9 | 32 | 17 | 175psi |
| SS312 | 1" | 62 | 20 | 10 | 40 | 22 | 175psi |