

# Quick Release Pneumatic Hose Couplings

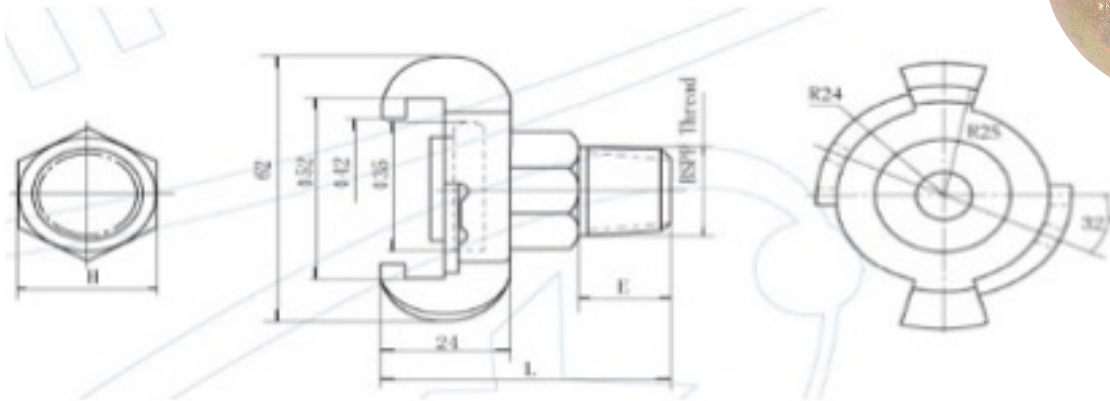

## European Execution Double Lock Claw Couplings

Q2 Female Thread, Plated, BSPP



- Robust couplings of malleable iron, zinc plated and yellow passivated (free of chrome VI)
- 100% couple test and sight control
- With oil-resistant rubber ring GOER, on request with steam-resistant rubber ring GDOR (up to 200°C) against charge
- Universal coupling, world-wide used system for compressed air in construction and industry

PART NO	SIZE	L	E	H	BSPP
Q3DLP14	1/4"	48	10	23	1/4"
Q3DLP38	3/8"	50	14	23	3/8"
Q3DLP12	1/2"	50	16	28	1/2"
Q3DLP34	3/4"	47	15	32	3/4"
Q3DLP1	1"	50	18	40	1"
Q3DLP114	1.1/4"	50	20	48	1.1/4"

PART NO	HOSE I.D	MAX. WORKING PRESSURE	TEMP.	MATERIAL	SEAL	THREADS	MEDIUM	CLAW DISTANCE
Q3DLP14	1/4"	PN 10 BAR	-40°C-+95°C	Malleable Iron	NBR	BSPP	Compressed Air	42 MM
Q3DLP38	3/8"	PN 10 BAR	-40°C-+95°C	Malleable Iron	NBR	BSPP	Compressed Air	42 MM
Q3DLP12	1/2"	PN 10 BAR	-40°C-+95°C	Malleable Iron	NBR	BSPP	Compressed Air	42 MM
Q3DLP34	3/4"	PN 10 BAR	-40°C-+95°C	Malleable Iron	NBR	BSPP	Compressed Air	42 MM
Q3DLP1	1"	PN 10 BAR	-40°C-+95°C	Malleable Iron	NBR	BSPP	Compressed Air	42 MM
Q3DLP114	1.1/4"	PN 10 BAR	-40°C-+95°C	Malleable Iron	NBR	BSPP	Compressed Air	42 MM